

Flo Inflatable Belt Supplementary Instructions



Table of Contents

Installing/Removing Rear-Facing Car Seat	1
Installing Rear-Facing Car Seat With Inflatable Vehicle Belt	1
Removing Rear-Facing Car Seat Installed With Inflatable Vehicle Belt	7
Installing/Removing Forward-Facing Car Seat	8
Installing Forward-Facing Car Seat With Inflatable Vehicle Belt	8
Removing Forward-Facing Car Seat Installed With Inflatable Vehicle Belt	14

© Clek and Flo are registered trademarks of Clek Inc.
For a complete list of Clek Inc. trademarks please visit clekinc.com/trademarks.



Installing Rear-Facing Car Seat With Inflatable Vehicle Belt



WARNING – DEATH or SERIOUS INJURY can occur

- Use these instructions to replace the “Installing Rear-Facing Car Seat with Vehicle Belt” section in your car seat manual.
- Not all inflatable vehicle belts are safe for use with this car seat. Contact Clek Customer Service at 1-866-656-2462 to determine if the inflatable belts in your vehicle are approved for use with this car seat.
- Always use these supplementary instructions in addition to the instructions found in your car seat manual. Your car seat manual contains other important information about the use and installation of this car seat.
- Never use the Rear-Facing Belt Lock-offs when installing this car seat Rear-Facing using an inflatable vehicle belt.
- This car seat must be held tight at all times by the lap portion of the lap/shoulder belt.
 - Refer to the vehicle owner’s manual for information regarding car seat installation and inflatable vehicle belt use with a car seat.

Step 1

Prepare car seat for Rear-Facing Installation:

- Rotate Recline Foot to Rear-Facing position by pulling on edge of Recline Foot and rotating it towards the front of the seat until it locks in to position, as shown in **Figure 1**.
- Remove Seat Cushion and install Anti-Rebound Bar. See “Installing/Removing Anti-Rebound Bar” in your car seat manual.

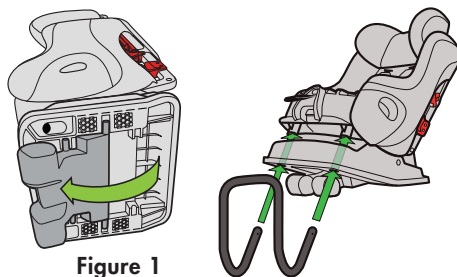

Figure 1

Step 2

Select a forward-facing vehicle seating location which has an inflatable vehicle belt which can be used with this car seat.

Step 3

If the vehicle seat back is adjustable, make sure the seat back is locked in a more upright position. Refer to vehicle owner's manual for recommended seat back angle. **DO NOT** install or use this car seat while the vehicle seat back is excessively reclined, as shown in **Figure 2**.



Figure 2

Step 4

Place car seat Rear-Facing in the vehicle seat location selected with Rear-Facing Belt Path toward vehicle seat back and centered in seating position as shown in **Figure 3**.

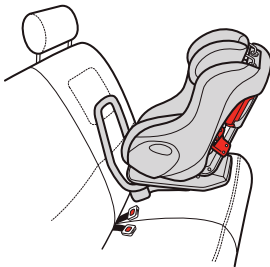

Figure 3

IMPORTANT: Car Seat base must **NOT** extend beyond the edge of the vehicle seat cushion as shown in **Figure 4**.

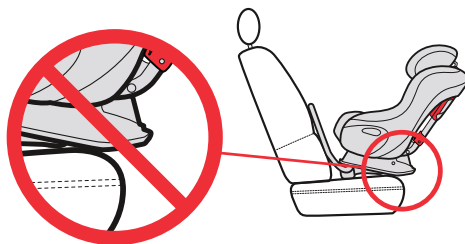

Figure 4

Step 5

Position the seat so that the Rear-Facing Level Reference Line appropriate for the child's weight is parallel with the ground as shown in **Figure 5**.

- If using with an infant under 10 kg (22lb), position the seat with the more reclined Reference Line (top line) parallel to the ground.
- If using with an older child who is over 10 kg (22lb), position the seat with the more upright Reference Line (bottom line) parallel to the ground.

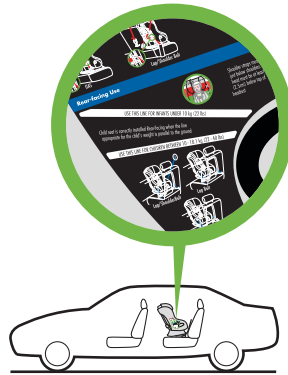

Figure 5

Step 6

Route vehicle belt through the Rear-Facing Belt Path and over both Rear-Facing Belt Lock-offs and buckle vehicle belt, as shown in **Figure 6**.

Position lap portion of inflatable lap/shoulder belt under both forward Belt Tabs and check that Crotch Strap is not under the vehicle belt.

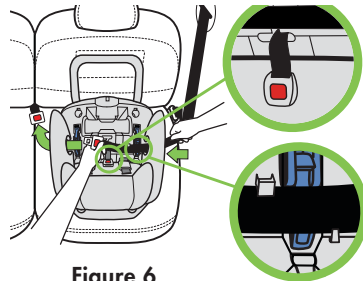

Figure 6

Step 7

Switch the the lap portion of the lap/shoulder belt to the automatic locking mode by pulling the lap portion of the lap/shoulder belt all the way out by holding the webbing and pulling upwards, as shown in your vehicle manual.

Step 8

Tighten vehicle belt to secure the car seat

- Press down in center of car seat to depress the vehicle cushion and pull down on the lap portion of inflatable lap/shoulder belt to tighten as shown in **Figure 7**.

NOTE: The lap portion of the inflatable lap/shoulder belt **MUST** remain tight and not lengthen when pressure is released from the seat. If the lap portion of the inflatable lap/shoulder belt does not remain tight, go back to Step 7 and refer to your vehicle manual.

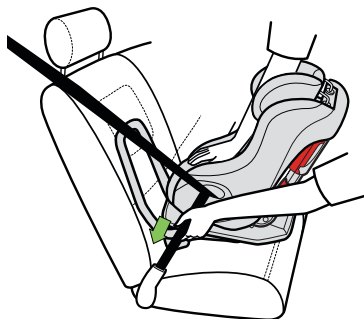

Figure 7

Step 9

Check for secure installation. Gripping car seat at top of armrests, pull car seat front to back and left to right to check for secure installation as shown in **Figure 8**. Vehicle belt **MUST** stay tight and child restraint should not move more than 2.5 cm (1 in.) in any direction.

- If vehicle belt still does not stay tight or car seat cannot be securely installed, try a different vehicle seat location or install using UAS, see “Installing Rear-Facing Car Seat With UAS” in your car seat manual.

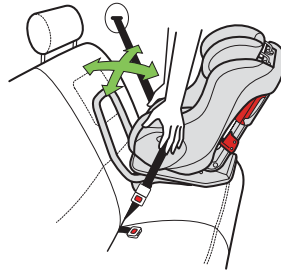

Figure 8

Step 10

Verify that the Rear-Facing Level Reference Line appropriate for the child’s weight is parallel to the ground as shown in **Figure 9**.

Step 11

Install Seat Cushion, see “Removing/Installing Seat Cushion” in your car seat manual.

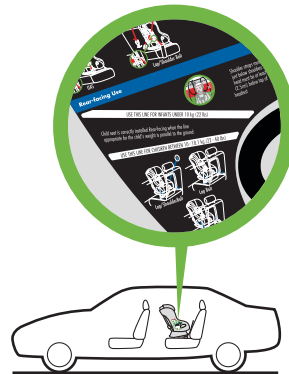

Figure 9



Removing Rear-Facing Car Seat Installed With Inflatable Vehicle Belt

Step 1

Unbuckle vehicle belt.

- Pressing down in center of car seat to reduce tension on vehicle belt will make it easier to unbuckle vehicle belt as shown in **Figure 10**.

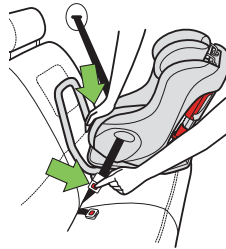

Figure 10

Step 2

Remove Seat Cushion, see “Removing/
Installing Seat Cushion” in your car
seat manual.

Step 3

Remove vehicle belt from Rear-Facing
Belt Path.

Step 4

Remove this car seat from vehicle.

Step 5

Install Seat Cushion, See “Removing/
Installing Seat Cushion” in your car
seat manual.



Installing Forward-Facing Car Seat With Inflatable Vehicle Belt



WARNING – DEATH or SERIOUS INJURY can occur

- Vehicle belt must be routed through Forward-Facing Belt Path and contained in both red Forward-Facing Belt Guides when using car seat Forward-Facing.
- Use these instructions to replace the “Installing Forward-Facing Car Seat with Vehicle Belt” section in your car seat manual.
- Not all inflatable vehicle belts are safe for use with this car seat. Contact Clek Customer Service at 1-866-656-2462 to determine if the inflatable belts in your vehicle are approved for use with this car seat.
- ALWAYS use these supplementary instructions in addition to the instructions found in your car seat manual. Your car seat manual contains other important information about the use and installation of this car seat.
- Forward-Facing Belt Lock-off must be left completely open when installing with an inflatable vehicle belt.

**! WARNING – DEATH or
SERIOUS INJURY can occur (continued)**

- ALWAYS secure the Top Tether.
- This car seat must be held tight at all times by the lap portion of the lap/shoulder belt.
 - Refer to the vehicle owner’s manual for information regarding car seat installation and inflatable vehicle belt use with a car seat.

Step 1

Prepare car seat for Forward-Facing Installation:

- Check that the Recline Foot is in the Forward-Facing position as shown in **Figure 11**. If needed, grasp forward edge of Recline Foot and rotate towards the back of the seat, pressing it in to the recess in the seat bottom.
- If the Anti-Rebound Bar is attached, remove it now. See “Installing/Removing Anti-Rebound Bar” in your car seat manual.

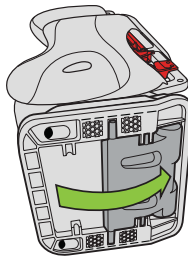

Figure 11

Step 2

Select a Forward-Facing vehicle seating location which has a vehicle belt which can be used with this seat and a top tether anchor point as shown in **Figure 12**.

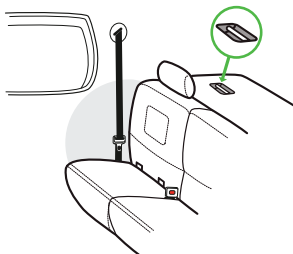

Figure 12

Step 3

If the vehicle seat back is adjustable, make sure the seat back is locked in a more upright position. Refer to vehicle owner's manual for recommended seat back angle. **DO NOT** install or use this car seat while the vehicle seat back is excessively reclined, as shown in **Figure 13**.



Figure 13

Step 4

Remove Tether Hook from its storage location on back of car seat. See "Top Tether Storage" in your car seat manual.

- Lengthen Top Tether belt by pressing and holding Tether Adjuster while pulling strap as shown in **Figure 14**.
- Place Tether Hook in the seat of the car seat.

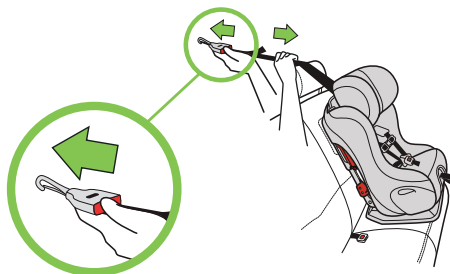

Figure 14

Step 5

Place car seat Forward-Facing in the vehicle seat location selected, and route vehicle belt through the Forward-Facing Belt Path. Take care not to put vehicle belt between Harness and back of seat, and buckle vehicle belt, as shown in **Figure 15**.

- Check that the lap portion of the inflatable lap/shoulder belt is contained in both red Forward-Facing Belt Guides.

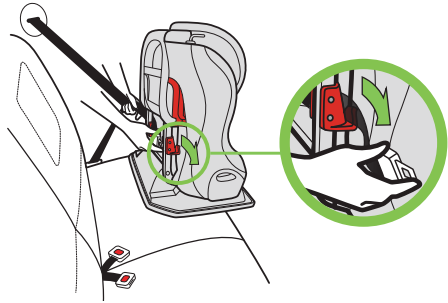

Figure 15

Step 6

Open the Forward-Facing Belt Lock-off on the same side of the seat as the vehicle shoulder belt anchor point. Place the vehicle shoulder belt through the Forward-Facing Belt Lock-off as shown in **Figure 16**.

Step 7

Switch the the lap portion of the inflatable lap/shoulder belt to the automatic locking mode by pulling the lap portion of the belt all the way out by holding the webbing and pulling upwards, as shown in your vehicle manual.

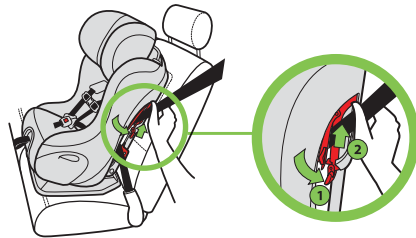

Figure 16

Step 8

Center car seat in the vehicle seating position chosen, and tighten vehicle belt to secure the car seat.

- Press down in center of car seat to depress the vehicle cushion and pull down on lap portion of inflatable vehicle belt to remove excess slack, as shown in **Figure 17**.
- Check that Forward-Facing Belt Lock-off is all the way open with Lock-tab rotated completely down and as close to the back metal support bar as possible, as shown in **Figure 18**.

IMPORTANT: NEVER lock or partially close Forward-Facing Belt Lock-off when using an inflatable vehicle belt.

IMPORTANT: The lap portion of the inflatable lap/shoulder belt **MUST** remain tight and not lengthen when pressure is released from the seat. If the lap portion of the inflatable lap/shoulder belt does not remain tight, go back to Step 7 and refer to your vehicle manual.

Step 9

Check that the entire belt is laying flat, placed correctly through both red Forward-Facing Belt Guides and **NOT** between the Harness and seat, as shown in **Figure 19**.



Figure 17

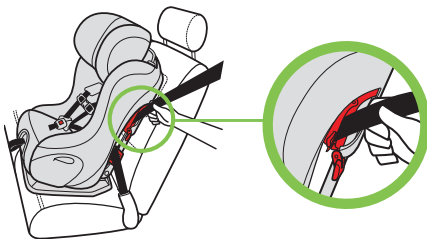

Figure 18

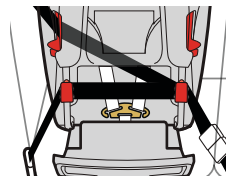

Figure 19

Step 10

Attach Tether Hook to vehicle top tether anchor as shown in **Figure 20** or **Figure 21** and pull firmly on free end of strap until Top Tether is snug.

Refer to vehicle owner's manual for recommended Top Tether routing and identification of top tether anchor point.

Step 11

Check for secure installation. Gripping car seat at top of armrests, pull car seat front to back and left to right to check for secure installation as shown in **Figure 22**. Vehicle belt and Top Tether must stay tight and child restraint should not move more than 2.5 cm (1 in.) in any direction.

- If vehicle belt does not stay tight or car seat cannot be securely installed, try a different vehicle seating location or install using UAS. See "Installing Forward-Facing Car Seat With UAS" in your car seat manual.

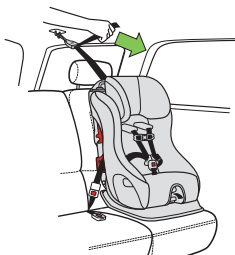

Figure 20

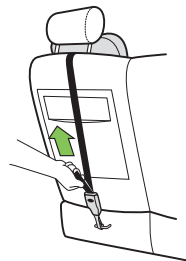

Figure 21



Figure 22



Removing Forward-Facing Car Seat Installed With Inflatable Vehicle Belt

Step 1

Loosen Top Tether by pressing and holding Tether Adjuster while pulling strap as shown in **Figure 23**.

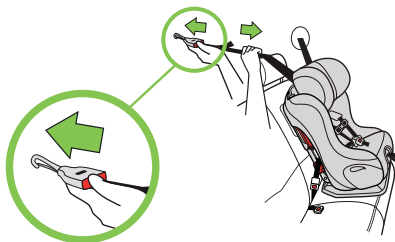

Figure 23

Step 2

Remove Tether Hook from vehicle tether anchor.

- Pull in and hold retention spring on Tether Hook, then remove hook from tether anchor as shown in **Figure 24** and **25**.

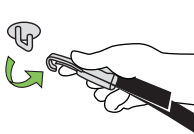

Figure 24



Figure 25

Step 3

Unbuckle inflatable vehicle belt and remove from Forward-Facing Belt Path.

- Pressing down in center of car seat to reduce tension on vehicle belt will make it easier to unbuckle vehicle belt as shown in **Figure 26**.

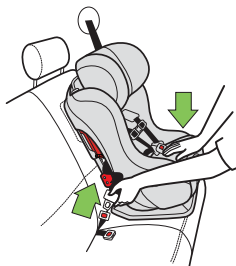

Figure 26

Step 4

Remove this car seat from vehicle.

Step 5

Store the Top Tether, see “Top Tether Storage” in your car seat manual.

Keep this Instruction Manual for future use. Store with car seat manual in Shoulder Harness Access Panel on back of this car seat.

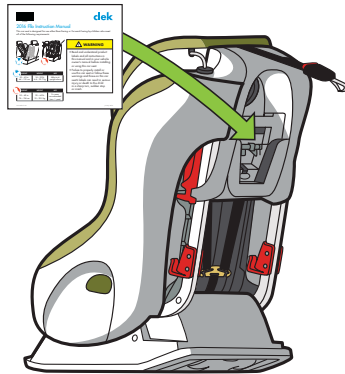

www.clekinc.com

Clek Inc.
226 Lesmill Road
Toronto, Ontario Canada
M3B 2T5
1-866-656-2462