

Foonf + Fflo
Q-Tether Manual

clek



WARNING – DEATH or SERIOUS INJURY can occur

Failure to properly install or use this accessory or follow these warnings and instructions, the instructions provided with your car seat, and the information on the car seat's labels can result in serious injury or death of the child in a sharp turn, sudden stop, or crash.

- Use only with Clek Foanf or Fflo convertible car seats.
- Only use Q-tether when installing Clek Foanf or Fflo convertible car seats rear-facing. NEVER use Q-tether when installing Foanf or Fflo forward-facing.
- Always adjust Q-Tether Connector Strap so that Splitter Plate is located on top of vehicle seat back. NEVER use Q-tether with Splitter Plate in front of vehicle seat back.
- Do not tighten Q-tether more than needed to remove slack. Overtightening Q-tether could shift the position of the car seat resulting in a seat too upright.
- Only connect Tether Hook to a designated tether anchor. NEVER connect Tether Hook to an unapproved anchor point.
- Only connect Tether Hook to the tether anchor dedicated for the seating position being used. NEVER connect Tether Hook to an adjacent tether anchor.

Checklist for Proper Use of Q-Tether

IMPORTANT: This is only a checklist – you must read and understand all of the warnings and instructions provided with your Clek car seat and in these instructions before installing or using the Q-Tether.

- ✓ Foof or Fflo is installed rear-facing according to car seat instruction manual.
- ✓ Tether Hook is connected to designated tether anchor.
- ✓ Q-Tether Connector Strap is tightened so that Splitter Plate is located on top of vehicle seat back.
- ✓ Loops at end of Q-Tether are properly attached to Splitter Plate and completely inside the slot.
- ✓ Q-Tether adjuster is located on side of vehicle where child will be loaded and unloaded.
- ✓ Q-Tether is correctly routed through both Forward-Facing Belt Lock-offs and both Lock-offs are closed.
- ✓ Q-Tether Strap must not pass between Shoulder Harness Straps and back of seat.
- ✓ Q-tether webbing is tightened to be snug without lifting or shifting position of car seat.

Vehicle Information

- Tether anchors have been provided in second row seating positions by most vehicle manufacturers since 2001.
- Top tether anchors are found behind the vehicle seat as shown in **Figure 1**.
- If covered, the tether anchor locations may be identified by a symbol as shown in **Figure 2**.
- See your vehicle owner's manual to identify what seating positions have a tether anchor.
- See your vehicle owner's manual for instructions on routing and connecting the Tether Hook relative to any vehicle features such as a vehicle headrest.

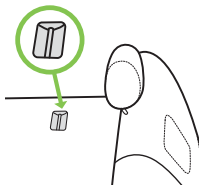

Figure 1



Figure 2

Q-Tether Features

- 1 Tether Hook
- 2 Q-Tether Connector Adjuster
- 3 Q-Tether Connector Strap
- 4 Splitter Plate
- 5 Q-Tether Attachment Loops
- 6 Q-Tether Adjuster
- 7 Q-Tether Strap

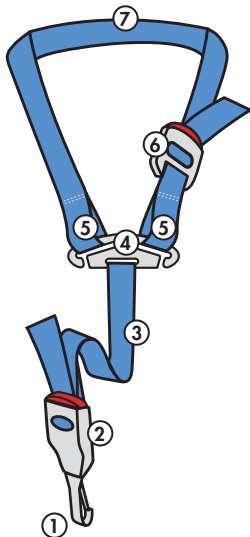

IMPORTANT: Car seat **MUST** be properly installed according to the instructions in the car seat manual in a vehicle seating position with a designated tether anchor before installing Q-Tether.

Installing Q-Tether

Step 1

Locate tether anchor as shown in **Figure 3**. If covered, the tether anchor may be identified by a symbol, as shown in **Figure 2**.

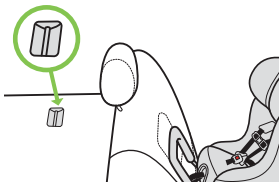

Figure 3

Step 2

Loosen Q-Tether Connector Strap by pressing and holding Q-Tether Connector Adjuster while pulling strap as shown in **Figure 4**.

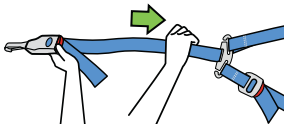

Figure 4

Step 3

Attach Tether Hook to vehicle tether anchor as shown in **Figure 5** or **6**.

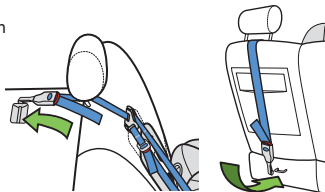

Figure 5

Figure 6

Step 4

Check that Q-Tether Adjuster is connected to side of Splitter Plate closest to where child will be loaded and unloaded.

Option 1: If Q-Tether Adjuster needs to be moved to other side of Splitter Plate:

- Remove loop at each end of Q-Tether Strap from Splitter Plate by sliding strap out through slot in Splitter Plate as shown in **Figure 7**.
- Position Q-Tether Strap so that Adjuster is located on side of Splitter Plate closest to where child will be loaded and unloaded.

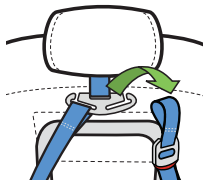

Figure 7

- Attach loop at end of Q-Tether Strap by sliding looped end into slot in Splitter Plate as shown in **Figure 8**.

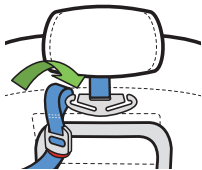

Figure 8

Option 2: If Q-Tether Adjuster is on correct side of Splitter Plate:

- Remove one loop at end of Q-Tether Strap from Splitter Plate by sliding strap out through slot in Splitter Plate as shown in **Figure 9**.

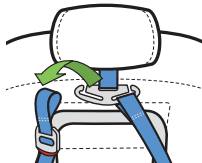

Figure 9

Step 5

Press and hold Q-Tether Adjuster and pull out on Q-Tether Strap until Strap reaches full length as shown in **Figure 10**.

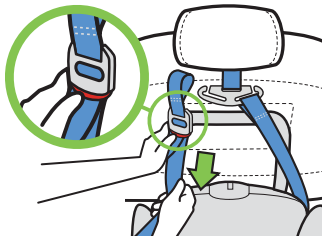

Figure 10

Step 6

Open both Forward-Facing Belt Lock-offs as shown in **Figure 11**.

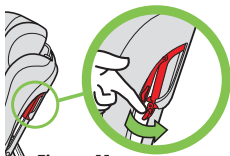

Figure 11

Step 7

Route looped end of Q-Tether Strap through Forward-Facing Belt Path, taking care that Q-Tether Strap is NOT between the Harness and seat, as shown in **Figure 12**.

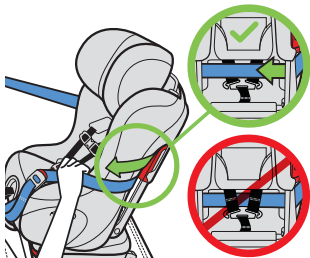

Figure 12

Step 8

IMPORTANT: Check that Q-Tether Strap is flat and not twisted before attaching loop to Splitter Plate.

Attach loop at end of Q-Tether Strap to Splitter Plate by sliding Strap into slot in Splitter Plate as shown in **Figure 13**.

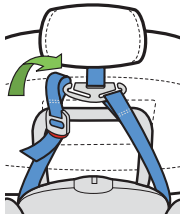

Figure 13

Step 9

Pull free end of Q-Tether Connector Strap until Splitter Plate is positioned on top of vehicle seat back as shown in **Figure 14**.

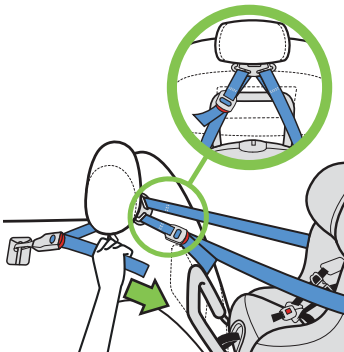

Figure 14

IMPORTANT: To prevent injury to the child in a sudden stop or crash Splitter Plate **MUST** be positioned on top of vehicle seat back and never in front of vehicle seat back where the child's head could strike as shown in **Figure 15**. Contact Clek Customer Service at 1-866-656-2462 if unable to obtain correct position of Splitter Plate.

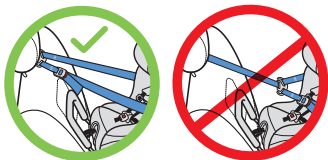

Figure 15

Step 10

Position Q-Tether Strap so that it passes through both Forward-Facing Belt Lock-offs and pull on free end of Q-Tether Strap to tighten as shown in **Figure 16** and **17**.

IMPORTANT: NEVER tighten Q-Tether Strap further than needed to remove slack. If rear-facing recline shifts when tightening Q-Tether, too much slack has been removed.

Step 11

Check that Q-Tether Strap is within both Forward-Facing Lock-offs and lock both Forward-Facing Belt Lock-offs as shown in **Figure 18**.

NOTE: If recline angle shifts when closing Lock-offs, reopen Lock-Offs and loosen Q-Tether Strap a small amount before closing Lock-offs.

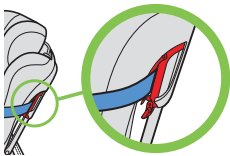

Figure 16

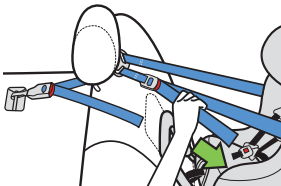

Figure 17

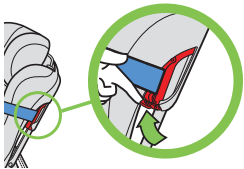

Figure 18

Final Check

- ✓ Car seat is installed rear-facing according to instruction manual.
- ✓ Tether Hook is connected to the designated tether anchor.
- ✓ Q-Tether Connector Strap is tightened so that Splitter Plate is located on top of vehicle seat back.
- ✓ Loop at each end of Q-Tether Strap is completely inside corresponding slot in Splitter Plate.
- ✓ Q-Tether Strap is routed through Forward-Facing Belt Path and not between Shoulder Harness Straps and Car Seat.
- ✓ Q-Tether Strap is tightened so that slack is removed without shifting the recline angle of the car seat.
- ✓ Q-Tether Strap is positioned in both Forward-Facing Lock-offs and both Forward-Facing Lock-offs are closed.
- ✓ Q-Tether Adjuster is located on side of seat closest to where child will be loaded and unloaded.

Loading/Unloading Child

For ease of loading and unloading, it is recommended that Q-Tether be loosened and then re-tightened each trip.

Loosening Q-Tether

Press and hold Q-Tether adjuster and pull out on Q-Tether Strap until Strap reaches full length as shown in **Figure 19**.

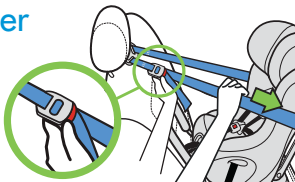

Figure 19

Tightening Q-Tether

Pull free end of Q-Tether Strap until slack is removed as shown in **Figure 20**.

IMPORTANT: NEVER tighten Q-Tether Strap further than needed to remove slack. If rear-facing recline shifts when tightening Q-Tether, too much slack has been removed.

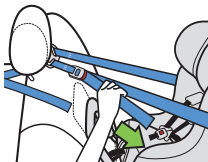

Figure 20

Troubleshooting

For instructions on troubleshooting your Clek product, please visit:
www.clekinc.com/support/q-tether

Accessories

Optional Clek accessories may be purchased at:
www.clekinc.com/accessories

Warranty

Clek Inc. warrants only to the original consumer purchaser and only if this product was purchased (new and unused in an unopened box) from an authorized Clek retailer listed at www.clekinc.com, that this product will be free from defects in material and workmanship for one (1) years from the date of original purchase (the "Warranty Period"). During the Warranty Period, Clek Inc. will, at its option, repair or replace this product if it is found by the manufacturer to be defective in material or workmanship. Clek Inc. reserves the right to discontinue or change parts, fabrics, models, or products, or to substitute this product with a comparable model or product. To make a claim under this warranty, please contact us at www.clekinc.com/contact_us, call us at: 1-866-656-2462, or write to us at Clek Inc., 226 Lesmill Road, Toronto, Ontario, Canada, M3B 2T5. An original receipt is required to validate your warranty and shipping charges will be the responsibility of the original consumer purchaser.

clek