



IT21A



Infant-thingy Instruction Manual

Infant Insert for use with Clek Foonf and Fflo Car Seats

IMPORTANT: This is only a checklist — you must read and understand all of the warnings and instructions provided with your Clek car seat and in this manual before installing or using this Infant Insert.

Checklist for Proper Use

- ✓ Infant weighs between 5 and 22 lb (2.3 and 10 kg) and is between 19 and 33 in. (48 and 85 cm) tall.
- ✓ Car Seat is properly installed Rear-Facing at maximum recline according to the car seat instruction manual.
- ✓ Crotch Strap is properly adjusted to the car seat's rear Crotch Strap Slot position and inserted through Crotch Buckle Slot in Body Support.
- ✓ Shoulder Harness Straps are through Shoulder Harness Slots closest to and at or below the shoulder of the child OR adjusted to the lowest Shoulder Harness Slots if infant's shoulders are below the lowest Shoulder Harness Slots.
- ✓ Head Support Attachment Tabs are secured through 3rd set of Shoulder Harness Slots above the Shoulder Harness Straps.



WEIGHT	HEIGHT
5 – 22 lb (2.3 – 10 kg)	19 – 33 in. (48 – 85 cm)

- ✓ Top of infant's head is within Head Support.
- ✓ EITHER the Head Support OR car seat Headrest is in use and adjusted according to instructions provided in "Installing/Removing Head Support " Section.
- ✓ Crotch Buckle Pad is installed and positioned between Buckle and infant's body.
- ✓ Harness is snugly adjusted on child and buckled.
- ✓ Body Support is used if child's weight is less than 11 lb (5 kg) or if the car seat Headrest is used.

Infant-thingy Features

- 1 Head Support
- 2 Head Support Attachment Tabs
- 3 Body Support
- 4 Thigh Support (Body Support)
- 5 Hip Support (Body Support)
- 6 Crotch Strap Slot (Body Support)

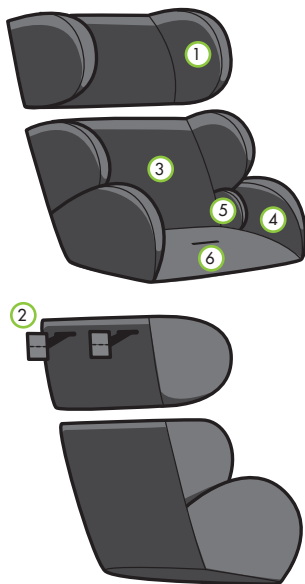

Table of Contents

Checklist for Proper Use	i
Infant-thingy Features	ii
Warnings	2
Adjusting Car Seat to Install Insert	5
Remove Headrest	5
Crotch Strap Adjustment	7
Shoulder Harness Adjustment	10
Shoulder Harness Slot Selection	10
Shoulder Harness Height Adjustment	11
Shoulder Harness Unthreading	11
Shoulder Harness Rethreading	13
To Shorten the Shoulder Harness Webbing	14
Installing/Removing Body Support	15
Installing Body Support	15
Removing Body Support	17
Installing/Removing Head Support	18
Installing Head Support	19
Removing Head Support	21
Care and Cleaning	24
Instruction Manual Storage	25
How to Receive Spanish Instructions (Cómo recibir las instrucciones en español)	25

 **WARNING – DEATH or
SERIOUS INJURY can occur**

Failure to properly install or use this insert or follow these warnings and instructions, the instructions provided with your car seat, and the information on the car seat's labels can result in serious injury or death of the child in a sharp turn, sudden stop, or crash.

- Use Infant Insert only with infants who weigh between 5 and 22 lb (2.3 and 10 kg) and whose height is between 19 and 33 in. (48 to 85 cm) tall.
- Discontinue use of the Head Support and install the car seat Headrest when top of child's head is at or above the top of the Head Support in its highest adjustment position.
- EITHER the Head Support OR car seat Headrest MUST be used at all times. NEVER use the Head Support and car seat Headrest at the same time.
- The Head Support must be used until the child weighs at least 14 lb (6.4 kg) AND is at least 25 in. (64 cm) tall AND is able to sit upright alone OR until car seat Headrest use is required.
- Body Support MUST be used with children:
 - who weigh 11 lb (5 kg) or less.
 - who must use the Car Seat Headrest but who weigh less than 14 lb (6.4 kg) or whose height is less than 25 in. (64 cm) or who are not able to sit upright alone.



WARNING – DEATH or SERIOUS INJURY can occur (continued)

- Use only with Clek Foonf or Fillo convertible car seats.
- Always install car seat in the most reclined position provided on the car seat labels to protect an infant’s airway. A seat too upright could result in an infant’s head falling forward, which could restrict their ability to breath. A seat too reclined can increase the risk of injury in a crash.
- Consult your infant’s doctor before using with a preterm or low birth weight infant.
- Always use the car seat’s rear Crotch Strap Slot when using Body Support. Never use the car seat’s forward Crotch Strap Slot when using Body Support.
- Always use Buckle Pad with Infant Insert.
- Use Infant Insert only when car seat is installed in a Rear-Facing position.
- Adjust the height of the Shoulder Harness Straps and Head Support as your infant grows to ensure proper harness fit.
 - ALWAYS check harness strap height after removing or installing Body Support.



WARNING – DEATH or SERIOUS INJURY can occur (continued)

- Head Support Attachment Tabs must be secured through at least the 3rd set of Shoulder Harness Slots above the Shoulder Harness Straps.
 - If the top of infant's head is above the top of the Head Support, secure the Head Support Attachment Tabs through the 4th set of Shoulder Harness Slots above the Shoulder Harness Straps or remove Head Support and install car seat Headrest.
- Discontinue use of Infant Insert when:
 - Infant's weight exceeds 22 lbs (10 kg) OR
 - Infant's height exceeds 33 in. (85 cm)
- Never use additional padding behind or under infant. Extra padding or bulky clothing may prevent the Harness from being properly adjusted which may increase the risk of injury in a crash or sudden stop.
- Never leave infant in car seat when Harness is not buckled and properly adjusted, infants can strangle on loose Harness Straps.
- Never leave infant unattended.
- When using Infant Insert, follow this manual when there is a disagreement between your Car Seat manual and the Infant Insert manual.

Adjusting Car Seat to Install Insert

Remove Headrest (when Head Support will be used)

NOTE: Car seat ships with Headrest already removed.

 **WARNING – DEATH or
SERIOUS INJURY can occur**

- Either the Head Support or car seat Headrest **MUST** be used at all times. **NEVER** use the Head Support and car seat Headrest at the same time.
- Discontinue use of Infant Insert when:
 - Infant's weight exceeds 22 lb (10 kg) **OR**
 - Infant's height exceeds 33 in. (85 cm)
- Discontinue use of the Head Support and install the car seat Headrest when top of child's head is at or above the top of the Head Support in its highest adjustment position.

Step 1

Locate the Troubleshooting Tool behind the manual on the back of the car seat, as shown in **Figure 1**.

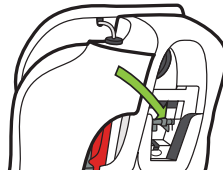

Figure 1

Step 2

Raise Headrest to highest position by pressing and holding Headrest Adjuster button while lifting up on Headrest.

Step 3

Insert trouble shooting tool into the small hole in the front of the Headrest Guide on the left side of the seat as you are facing it, as shown in **Figure 2**.

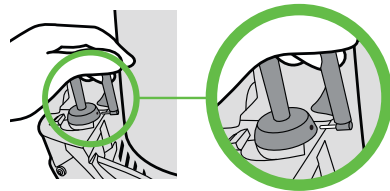

Figure 2

Step 4

Push in on the Troubleshooting Tool and the Headrest Adjuster button and hold both in while pulling up on the Headrest, as shown in **Figure 3**.

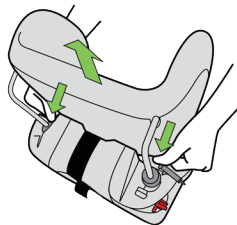

Figure 3

Note: A paper clip or other small object may be used if the Troubleshooting Tool is not available.

IMPORTANT: Car seat Headrest **MUST** be installed if using the car seat without the Head Support.

Crotch Strap Adjustment (Car Seat)



**WARNING – DEATH or
SERIOUS INJURY can occur**

- Use only the car seat's rear Crotch Strap Slot when using Body Support.
- NEVER use the longer Crotch Strap length in the rear Crotch Strap Slot when not using the Body Support. Follow all instructions for Crotch Strap adjustment in your car seat manual once the Body Support is removed.

Step 1

Remove the seat cushion. See "Removing/
Installing Seat Cushion" in your car
seat manual.

Step 2

Ensure that the Crotch Strap is adjusted to the
rear Crotch Strap Slot and is adjusted to the
proper length to fit the child.

To move the Crotch Strap from the forward Crotch Strap Slot to the rear Crotch Strap Slot:

- Slide the belt to one side of the Crotch Strap Slot and push the edge of the belt into the adjustment slot as shown in **Figure 4**.
- Slide the Crotch Strap into the rear Crotch Strap Slot as shown in **Figure 5**, ensuring that the red release button on the buckle faces out of the seat as shown in **Figure 6**.

NOTE: For larger infants, the Crotch Strap can be lengthened. The longer Crotch Strap length may only be used in the rear Crotch Strap Slot when the Body Support is installed.

To lengthen the Crotch Strap:

- Slide the belt to one side of the Crotch Strap Slot and push the edge of the belt into the adjustment slot as shown in **Figure 7**.
- Slide the Crotch Strap out of the Crotch Strap Slot as shown in **Figure 8**.

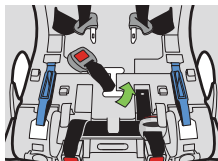

Figure 4

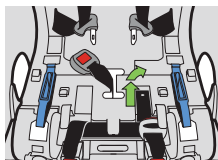

Figure 5

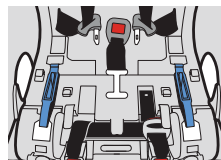

Figure 6

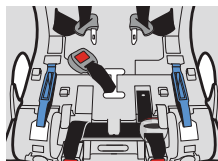

Figure 7

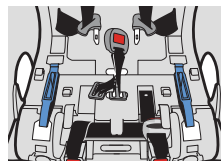

Figure 8

- Select the longer Crotch Strap length and slide the Crotch Strap into the rear Crotch Strap Slot as shown in **Figure 9**, ensuring that the red release button on the buckle faces out of the seat as shown in **Figure 10**.

Step 3

Install the Seat Cushion, see “Removing/
Installing Seat Cushion” in your car
seat manual.

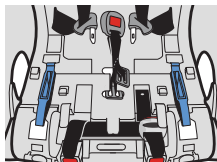

Figure 9

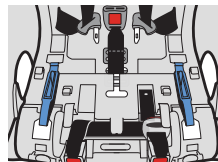

Figure 10

Shoulder Harness Adjustment

WARNING – DEATH or SERIOUS INJURY can occur

- To prevent loose harness and risk of ejection in a crash:
 - Loops at the end of the Shoulder Harness Straps must be properly attached to the Metal Harness Plate.
 - Harness must be properly routed under bottom of seat back cover.
 - Shoulder Harness Straps must be routed through harness slots at the same height on each side and in the pad and seat back.

SHOULDER HARNESS SLOT SELECTION

Step 1

If using the Body Support, place the Body Support on the seat cushion as show in **Figure 11**.

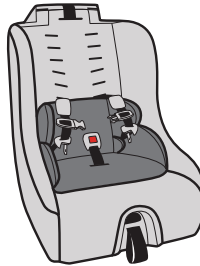

Figure 11

Step 2

Place the child in seat and determine the Shoulder Harness Slots at or just below and closest to the shoulders of your child as shown in **Figure 12**.

NOTE: If child's shoulders are lower than the lowest Shoulder Harness Slots, adjust Shoulder Harness Straps to the lowest Shoulder Harness Slots. Harness must remain in the lowest set of Shoulder Harness Slots until the child's shoulders reach the second set of Shoulder Harness Slots from the bottom.



Figure 12

SHOULDER HARNESS HEIGHT ADJUSTMENT

SHOULDER HARNESS UNTHREADING

Step 1

Loosen Harness to largest size:

While lifting up on Harness Adjuster Tab, pull out on Shoulder Harness Straps until they stop as shown in **Figure 13**.

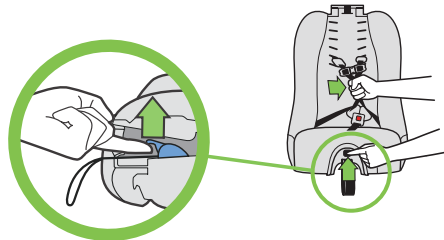

Figure 13

Step 2

Remove Top Tether from storage:

Remove car seat Instruction Manual and Tether Belt from back of seat. Pull in and hold retention spring on Tether Hook, then remove hook from storage bar as shown in **Figure 14**.

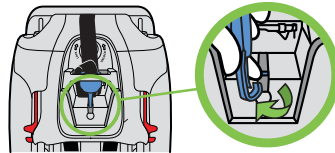

Figure 14

Step 3

Remove Shoulder Harness Access Panel from back of car seat:

- Twist the Access Panel lock counter-clockwise and pull to remove as shown in **Figure 15**.

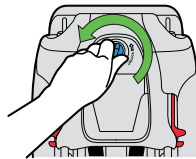

Figure 15

Step 4

Remove loops at ends of Shoulder Harness Straps from Metal Harness Plate by sliding strap out through slot in Metal Harness Plate as shown in **Figure 16**.

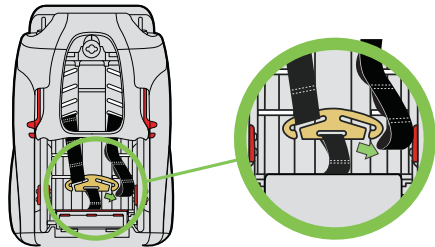

Figure 16

Step 5

From front of car seat, pull Shoulder Harness Straps out of seat back.

SHOULDER HARNESS RETHREADING

Step 1

Check that Harness Straps are not twisted and, from front of seat, insert Shoulder Harness Straps through the chosen Shoulder Harness Slots as shown in **Figure 17**. Straps **MUST** go through the Shoulder Harness Slots at the same height on each side.

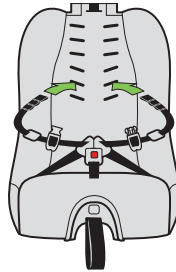

Figure 17

Step 2

Route Shoulder Harness under bottom of seat back cover (1) as shown in **Figure 18**.

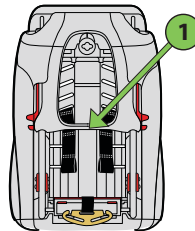

Figure 18

Step 3

Attach desired loops at end of Shoulder Harness Straps to Metal Harness Plate by sliding strap into slot in plate as shown in **Figure 19**.

NOTE: The loops which are located further in from the end of the Shoulder Harness Straps will provide better fit for infants using the Infant Insert.

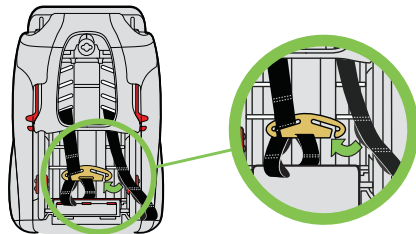

Figure 19

TO SHORTEN THE SHOULDER HARNESS WEBBING

For newborns and smaller infants: to make the Harness shorter, attach the Metal Harness Plate to the loop further in from the end of the Shoulder Harness Strap as shown in **Figure 20**.

Check that both Shoulder Harness Straps are attached to the Metal Harness Plate on the same loop while ensuring that each Shoulder Harness Strap is completely inside the slot in Metal Harness Plate as shown in **Figure 21**.

Step 4

Reattach Shoulder Harness Access Panel to back of car seat:

- Insert the access panel and twist the access panel lock clockwise as shown in **Figure 22**.

Step 5

Hook Tether Hook around storage bar as shown in **Figure 23**, fold the Top Tether Belt and insert into Tether Storage. Replace Instruction Manual.

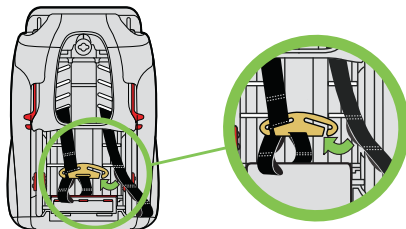

Figure 20

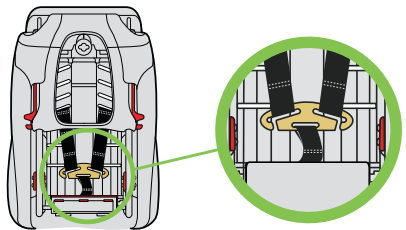

Figure 21

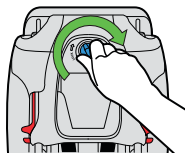

Figure 22

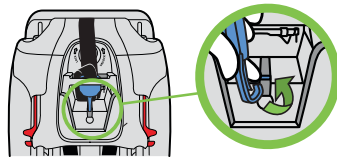

Figure 23

Installing/Removing Body Support



**WARNING – DEATH or
SERIOUS INJURY can occur**

- Always use Buckle Pad with Infant Insert.
- Body Support **MUST** be used with children:
 - who weigh 11 lb (5 kg) or less.
 - who must use the Car Seat Headrest but who weigh less than 14 lb (6.4 kg) or whose height is less than 25 in. (64 cm) or who are not able to sit upright alone.

Installing Body Support

Step 1

Remove Buckle Pad, if installed.

Step 2

Place Body Support on Seat Cushion and insert Crotch Strap through Crotch Strap Slot in the Body Support as shown in **Figure 24**.

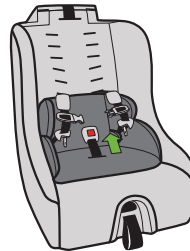

Figure 24

Step 3

Position each Harness Strap so that the Harness is in front of the Body Support. Check that the Harness Hip Straps come through the space between the Hip Support and Thigh Support sections of the Body Support, as shown in **Figure 25**.

Pull forward on Harness Straps to remove any excess harness webbing between the car seat and the Body Support.

NOTE: When Harness is properly positioned over the Body Support, the Hip Support will be positioned toward the infant's body, as shown in **Figure 25a**.

Step 4

Install Buckle Pad by inserting Buckle through slot in Buckle Pad and place Buckle Pad behind Buckle so it will be between child's crotch and Buckle as shown in **Figure 26**.

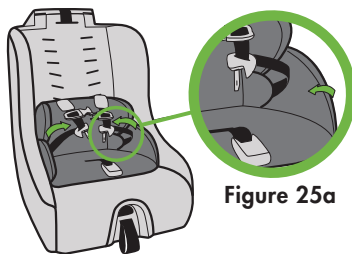

Figure 25

Figure 25a



Figure 26

Removing Body Support

Step 1

Remove Buckle Pad from Crotch Strap.

Step 2

Loosen Harness and set each Harness Strap to the side.

Step 3

Remove Body Support from seating area.

IMPORTANT: It may be necessary to adjust Harness height and/or Crotch Strap position or Crotch Strap length after removing Body Support. The Crotch Strap cannot be used in the long length position when placed in the rear Crotch Strap Slot after Body Support is removed. See “Shoulder Harness Adjustment” and “Crotch Strap Adjustment” instructions in your car seat manual to adjust seat when not using the Body Support.

Installing/Removing Head Support



WARNING – DEATH or SERIOUS INJURY can occur

- Either the Head Support or car seat Headrest **MUST** be used at all times.
- The Head Support must be used until the child weighs at least 14 lb (6.4 kg) **AND** is at least 25 in. (64 cm) tall **AND** is able to sit upright alone **OR** the child's head is at or above the top of the Head Support.
- Discontinue use of the Head Support and install the car seat Headrest when top of child's head is at or above the top of the Head Support in its highest adjustment position.
- **NEVER** use the Head Support and car seat Headrest at the same time.
- Head Support Attachment Tabs must be secured through at least the 3rd set of Shoulder Harness Slots above the Shoulder Harness Straps.
- Both Head Support Attachment Tabs must be secured through Shoulder Harness Slots at the same height on each side.

Installing Head Support

Step 1

Remove Top Tether from storage:

Remove car seat Instruction Manual and Tether Belt from back of seat. Pull in and hold retention spring on Tether Hook, then remove hook from storage bar as shown in **Figure 27**.

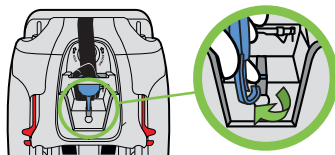

Figure 27

Step 2

Remove Shoulder Harness Access Panel from back of car seat:

- Twist the Access Panel lock counter-clockwise and pull to remove as shown in **Figure 28**.

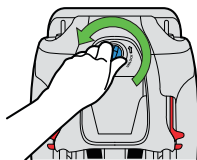

Figure 28

Step 3

Locate the third set of Shoulder Harness Slots above the Shoulder Harness Straps and position the Head Support above the Body Support so that the Head Support Attachment Tabs are facing the car seat.

IMPORTANT: Make sure the Head Support is positioned so that the Head Support Attachment Tabs are closest to the top of the Head Support.

Insert each Head Support Attachment Tab through the third Shoulder Harness Slot above each Shoulder Harness Strap by inserting the narrow side of Attachment Tab through the Harness Slot as shown in **Figure 29**.

NOTE: If needed to maintain proper fit, the Head Support Attachment Tabs may be inserted through the fourth set of Shoulder Harness Slots above the Shoulder Harness Straps in order to prevent the top of child's head from going above the top of the Head Support.

Check back of car seat to make sure the Attachment Tabs are flat against back of shell, as shown in **Figure 30**.



Figure 29

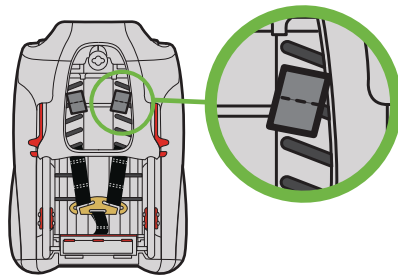

Figure 30

Step 4

Reattach Shoulder Harness Access Panel:

Insert the access panel and twist the access panel lock clockwise as shown in **Figure 31**.

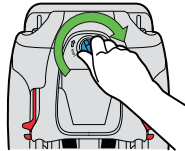

Figure 31

Step 5

Store the Top Tether by attaching Tether Hook around storage bar as shown in **Figure 32**, fold Top Tether belt and insert into Tether Storage. Replace car seat instruction manual.

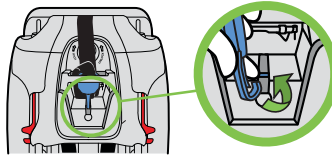

Figure 32

Removing Head Support

Step 1

Remove Top Tether from storage:

Remove car seat Instruction Manual and Tether Belt from back of seat. Pull in and hold retention spring on Tether Hook, then remove hook from storage bar as shown in **Figure 33**.

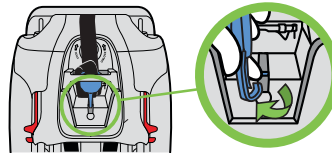

Figure 33

Step 2

Remove Shoulder Harness Access Panel from back of car seat:

Twist the access panel lock counter-clockwise and pull to remove as shown in **Figure 34**.

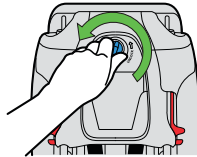

Figure 34

Step 3

From back of seat, insert narrow end of each Head Support Attachment Tab through each Harness Slot and continue to push each Attachment Tab through to front of seat as shown in **Figure 35**.

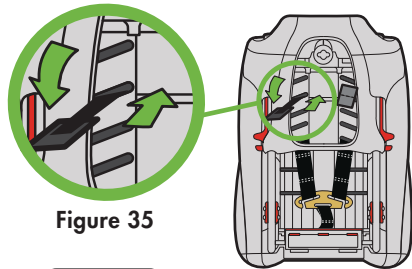

Figure 35

Step 4

Remove Head Support.

Step 5

Reattach Shoulder Harness Access Panel:

Insert the access panel and twist the access panel lock clockwise as shown in **Figure 36**.

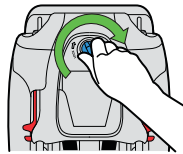

Figure 36

Step 6

Store the Tether by attaching Tether Hook around storage bar as shown in **Figure 37**, fold Tether belt and insert into Tether Storage. Replace car seat instruction manual.

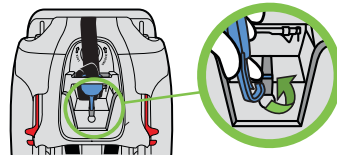

Figure 37

Step 7

Install car seat Headrest by inserting the Headrest support rods into the Headrest guides in the top of the seat back as shown in **Figure 38** and pushing the headrest down until it locks into position.

IMPORTANT: Car seat Headrest **MUST** be installed when Head Support is not in use.

NOTE: It may be necessary to insert the Troubleshooting Tool into the small hole in the front of the Headrest Guide on the left side of the seat as you are facing it, in order to install the headrest, as shown on Page 6.

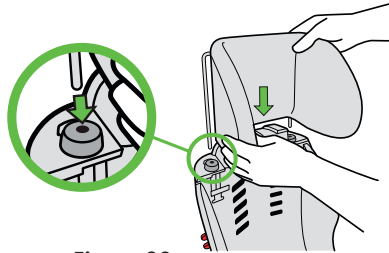

Figure 38

Care and Cleaning

Step 1

If the spot has dried, try lightly brushing or scraping off the residue. Wipe surface with water.

Step 2

If a spot still remains, apply a mild detergent to fabric with a light mist.

Step 3

Work area using soft brush or edge of spoon from outside of spot towards the middle.

Step 4

Allow solution to work for approximately one minute.

Step 5

Remove with clean water or blot with clean soft towel.

Step 6

Repeat steps 3-5 as necessary until spot is removed.

Step 7

Rinse with clear lukewarm water and blot with clean soft cloth as final step.

NOTE: If necessary due to heavy soiling, insert may be removed and hand washed with a mild detergent. Lay insert flat to dry.

Instruction Manual Storage

After carefully reading and following these instructions, keep this manual for future use and store with your Car Seat Instruction Manual in the compartment located in Shoulder Harness Access Panel, as shown in **Figure 39**.

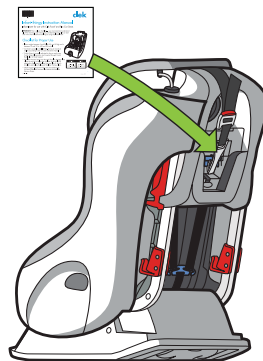

Figure 39

How To Receive Spanish Instructions

This instruction manual is also available in Spanish. To request a copy to be sent to you free of charge, please contact Clek Customer Service at 1-866-656-2462 or email us at customerservice@clekinc.com. You can also download a copy of the Infant-thingy instruction manual in Spanish online at www.clekinc.com/product-manuals

Cómo recibir las instrucciones en español

Este manual de instrucciones también está disponible en español. Para pedir que se le envíe una copia sin cargo alguno, tenga a bien ponerse en contacto con el servicio al cliente de Clek, para lo cual llame al 1-866-656-2462 o envíe un mensaje de correo electrónico a customerservice@clekinc.com. También puede descargar una copia del manual de instrucciones de Foonf en español por Internet en www.clekinc.com/product-manuals